

ProTek Systems, Inc. Installation Instruction

BR-800 Series Handrail

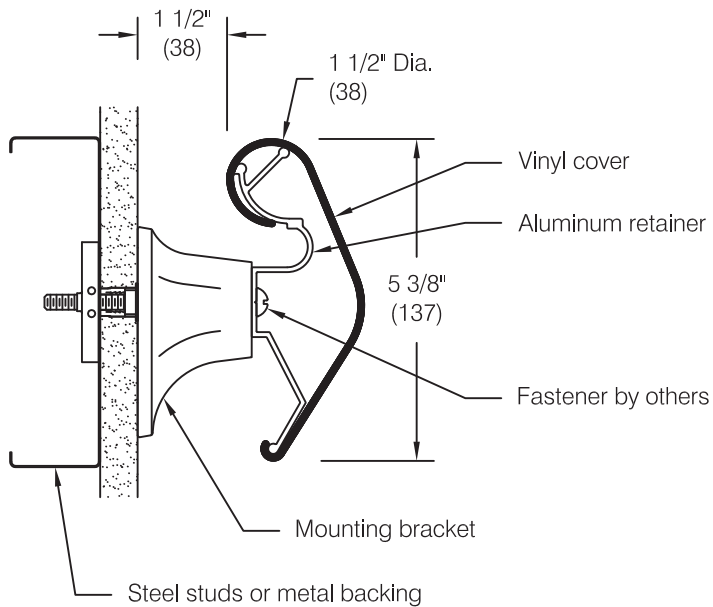

This installation instruction is applicable to:

BR-800

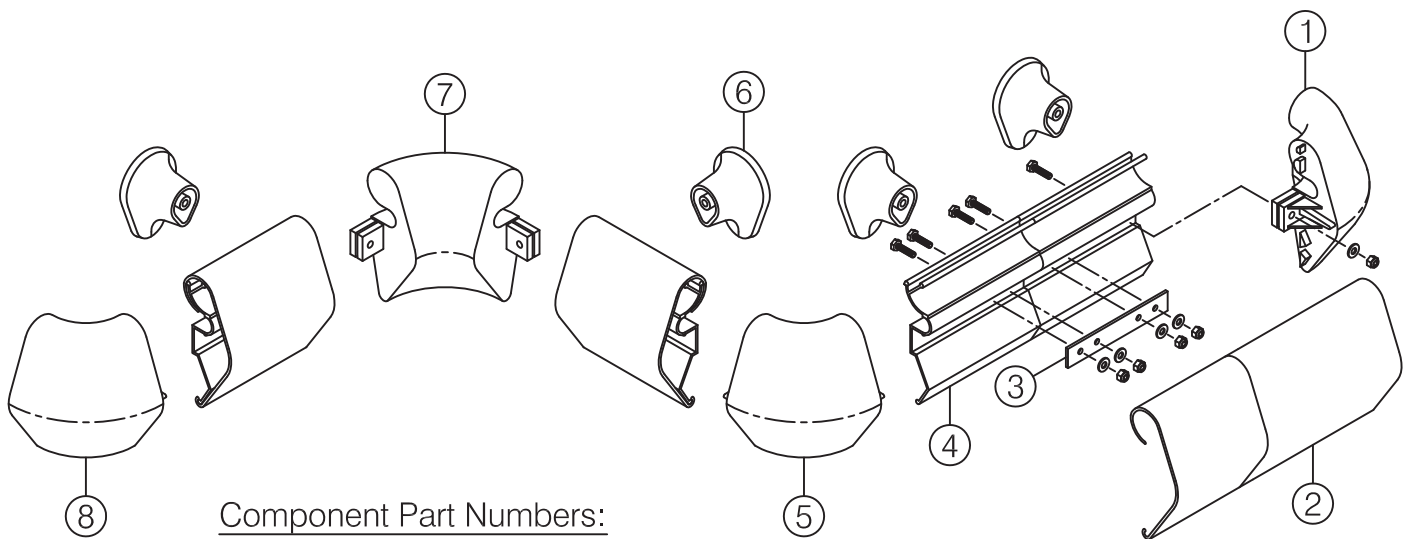

Component Part Numbers:

- 1) BRR-825 right return
- 2) BRV-800 vinyl cover
- 3) SPL-800 splice
- 4) BRA-800 aluminum retainer
- 5) OBR-850 outside corner
- 6) BR-107 bracket
- 7) IBR-875 inside corner
- 8) BRL-825 left return

BR-800 Handrail Installation Instructions

Step 1: Determine top of handrail height and snap a chalk line 2 ¾" below for centerline of mounting hardware, see **fig 1**.

Important: Store material in a clean dry place where the temperature is maintained above 50°F (10°C). Walls and rooms should be maintained at a minimum of 65°F (18°C) for at least 48 hours prior to installation. Acclimate materials to normal building conditions for at least 24 hours before cutting and installing.

Step 2: Cut aluminum retainer. See **Cutting Adjustment Diagrams and Schedule** for adjustments to aluminum retainer length at wall returns, inside corners and outside corners. Refer to **Minimum Layout Configurations** for additional information.

Important: All cuts must be square and deburred

Step 3: Layout aluminum retainer "face up", mark and drill bracket mounting hole locations.

Bracket mounting holes must be spaced:

- Not to exceed 32" on center
- 1 1/2" to 6" from end of aluminum retainer at returns and corner accessories
- A minimum of 4" from end of retainer at splices to avoid interference with splice hardware (shown in **fig 6**)
- To align with metal studs (on metal stud construction) or preferably with horizontal metal backer plate (by others)

Note: Use groove in retainer to locate centerline for drilling, see **fig 2**

Step 4: Locate and drill bracket mounting holes in wall construction using the aluminum retainer as a template or by careful measurement. Choice of hardware will dictate hole diameter.

Step 5: Insert molded accessories into end of retainer, press firmly to ensure molded part is seated squarely against the end of the retainer. Drill accessory mounting holes using the accessory as a template, see **fig 3**.

Step 6: Attach molded returns, outside corners and inside corners to retainer with accessory seated firmly and squarely while tightening. Fasten with ¼" bolt, flat washers and nylon lock-nut provided.

Caution: Do not use lock washers, use flat washers only. Install a flat washer between nut and rear molded tab and between bolt head and front molded tab. Tighten to 10 ft-lbs maximum torque, see **fig 4**.

Step 7: Mount assembly to wall with the appropriate hardware according to wall construction. See **step 8** for splicing information.

Suggested hardware:

- Drywall: Toggler® brand toggle bolts
- Masonry: Plastic Alligator® insert

Step 8: Refer to **fig 5** for splicing of aluminum retainer as required on longer handrail lengths. Always locate splice joints a minimum of 4" from bracket locations. For best results offset butt joint in cover from splice in aluminum retainer.

Step 9: Measure between accessories (corners and returns) and cut vinyl cover.

Important: All cuts must be square and deburred

Step 10: Snap cover in place over aluminum retainer.

BR-800 Series Handrail Installation Instructions

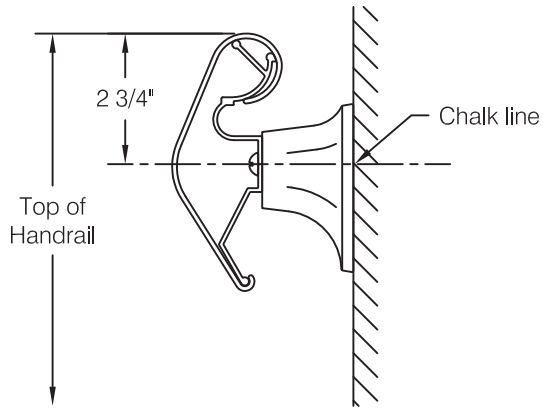

fig 1

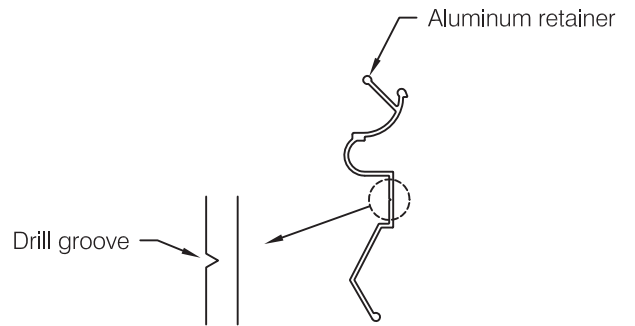

fig 2

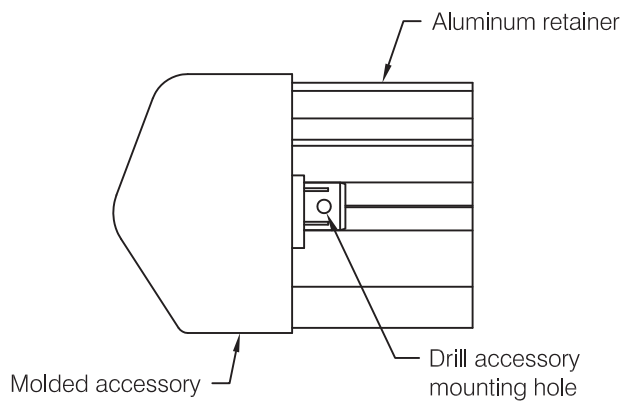

fig 3

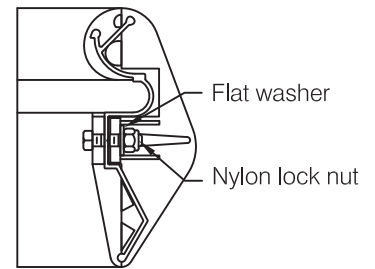

fig 4

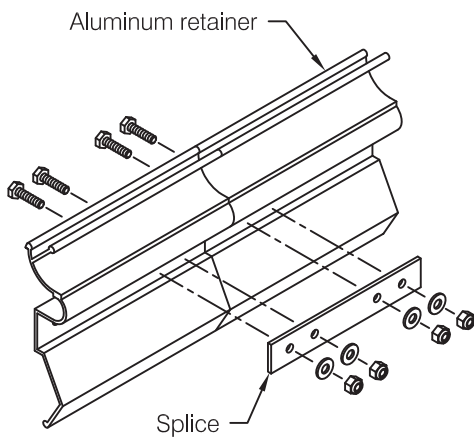
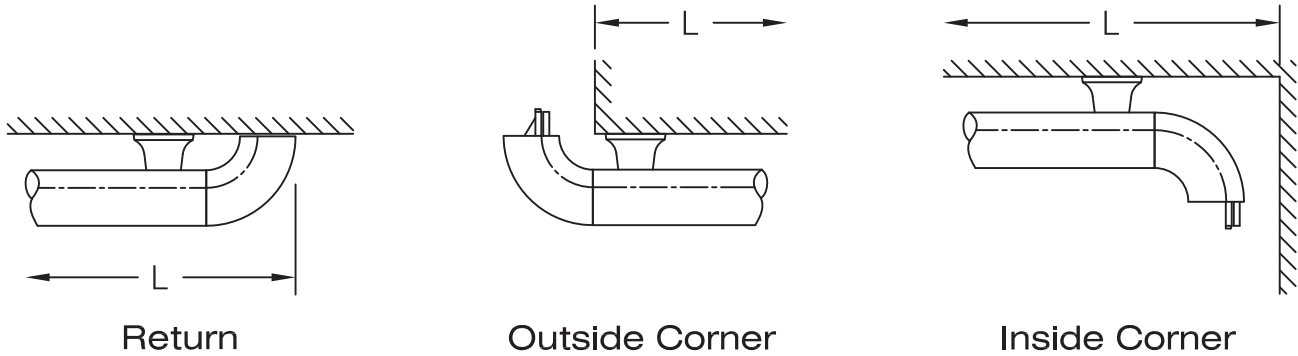

fig 5

BR-800 Series Handrail Installation Instructions

Cutting Adjustment Diagrams and Schedule



Aluminum Retainer & Vinyl Cover

Return	$L - 3 \frac{3}{4}"$
Outside Corner	$L + \frac{1}{16}"$
Inside Corner	$L - 5 \frac{3}{16}"$

Important: install aluminum retainer and molded accessories before cutting the snap-on cover.

Minimum Layout Configurations

